

Directions for June 18th, June 25th and August 14th 2011

New York

Bag Drop Off: June 18th 9 AM – 12 PM

Camper Drop Off: June 25th 9:30 AM

Camper Pick Up: August 14th 2PM

Bags will be returned to your home within a few days of camp
ending.

1&2 Jericho Plaza, Jericho, NY 11753

(see attached map)

When you enter the parking lot, please drive around Jericho Plaza 1 which will be on your left and park in the lot behind the building. The buses will be lined up along the North Service Road. Please do not block the buses.

If you need assistance with further directions, please call the camp office at (570)-756-2016 or email marah@campcaw.com

Consult the camp website for updated information.

Please use caution and be aware of moving vehicles while in the parking lot.

EXISTING PARKING = 2,580 SPACES (@10' X 20')
(BASED ON 5/1000 LESS CORE/MECH. SPACE)

JERICHO PLAZA—ONE
 -286,251 GROSS FLOOR AREA
 - 42,451 LESS CORE/MECH. SPACE
 -243,800 N.S.F.

PARKING PROVIDED = 243,800 ÷ 200 = 1,219 SPACES

JERICHO PLAZA—TWO
 -319,897 GROSS FLOOR AREA
 - 47,397 LESS CORE/MECH. SPACE
 -272,200 N.S.F.

PARKING PROVIDED = 272,200 ÷ 200 = 1,361 SPACES

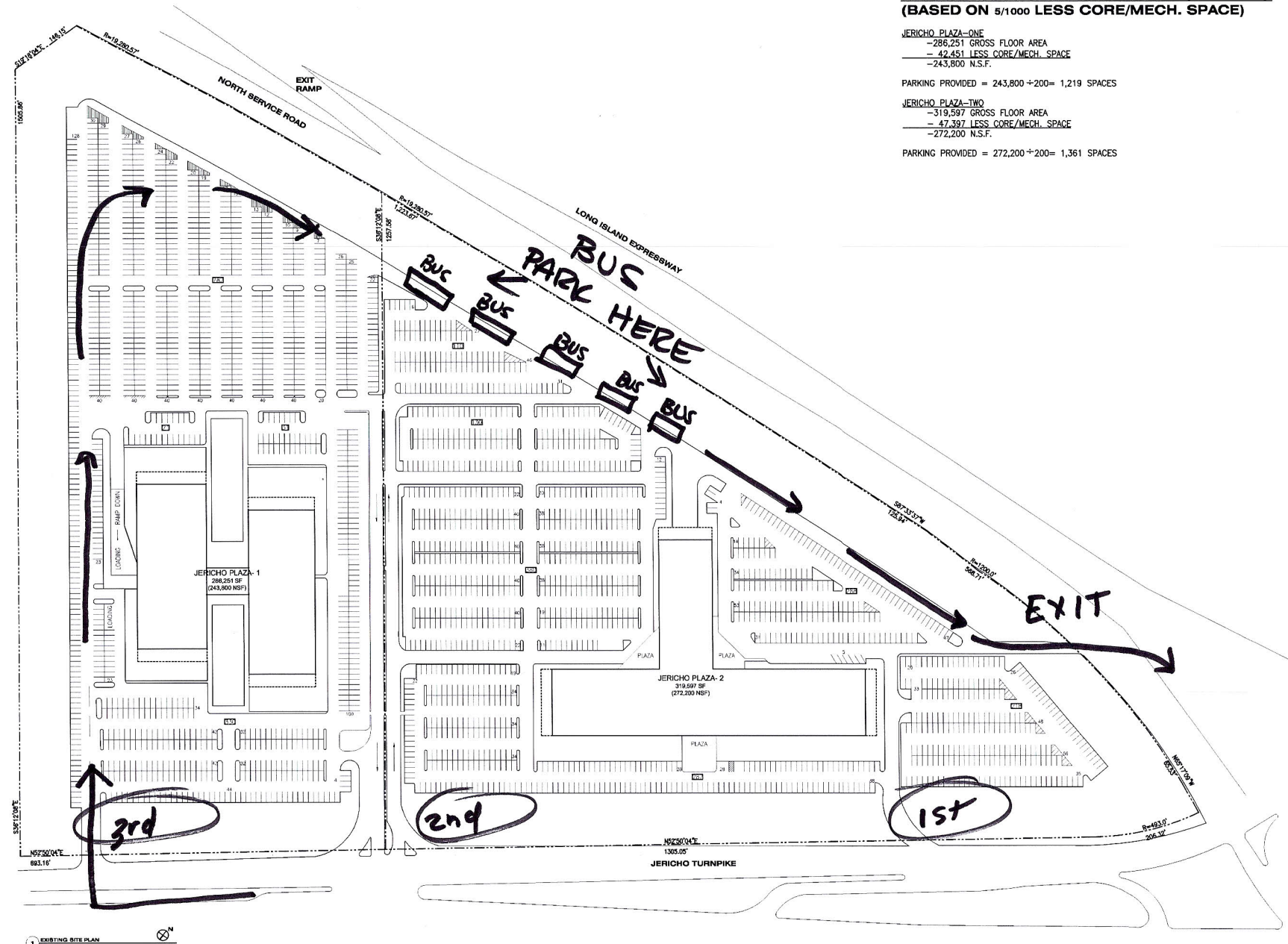

No. Issued Date
 1st Plan

Compass

spectrorgroup
 30111 New York Plaza Rd.
 Suite 500, 100-1100
 616-366-4242
 616-366-3601 Fax
 Architecture 1212 East 41st Street
 10017 New York, NY 10017
 Facility Planning 212-586-0066
 Project Management 212-586-1545 Fax
 New York • Long Island • New Jersey • Rhode Island • London

JERICHO PLAZA
 JERICHO, NEW YORK

Drawing Title
EXISTING SITE PLAN

JERICHO PLAZA ONE
JERICHO PLAZA TWO

Drawn By _____ Date 04/11/08
 Scale 1/4"=60'-0"
 Project No. 080804-00
 Revision 1.01 (DWG)
 These plans are an instrument of service and are the property of the architect. All rights are reserved.
 Sheet No.